

Epoxy resin insulators

Use our epoxy resin insulators for supporting busbar, mounting hardware or as mechanical standoffs. Rated for indoor use. Cover all popular voltage classes. Bolt pattern is directly compatible with our fuseclips listed at the end of this section.

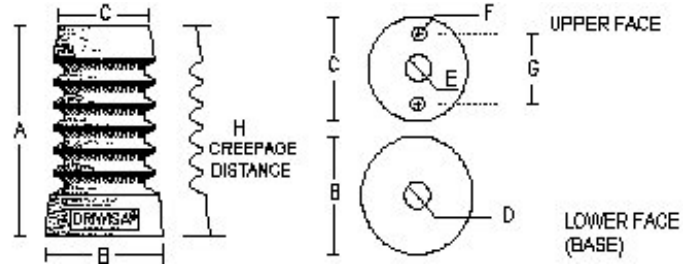

Cantilever Strength N			Dimensions - mm						
			A	B	C	D	E	F	G
DWA-07A	7.2	4000	100	60	60	1/2	3/8	1/4	115
DWA-15A	17.5	4000	165	75	57	5/8	3/8	1/4	230
DWA-20A	25.8	4000	210	82	57	5/8	3/8	1/4	290
DWA-30A	38.0	4000	300	100	71	5/8	3/8	1/4	430



45mm DIN fuse clips

The DIN fuse system's best feature is its guaranteed interchangeability. Our 45mm fuse clips will fit any DIN 43 625 HV DIN fuse regardless of origin. In addition, our clips deliver high pressure contacts, a safety backup spring, and bolt directly to our epoxy insulators listed elsewhere. They are available in 200 and 400A variants. The 400A version has a 'hot stick' operable bailing spring.

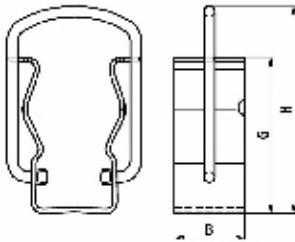

Part No.	
31 003 02.20	
B	1.26" (32mm)
G	2.80" (71.5mm)
H	3.74" (95mm)

31 003 02.20 (200A)

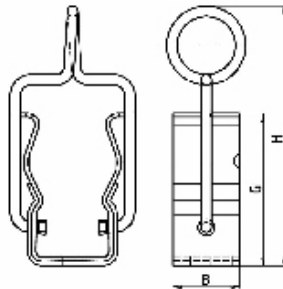

Part No.	
34 001 01.20	
B	1.26" (32mm)
G	2.90" (73.5mm)
H	4.82" (123mm)

34 001 02.20 (400A)

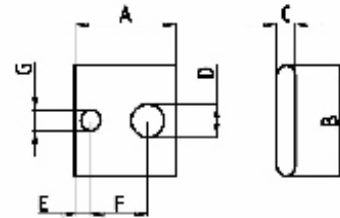

A	1.26" (32mm)
B	1.30" (35mm)
C	0.24" (6mm)
D	0.40" (10mm)
E	0.20" (5mm)
F	0.70" (18mm)
Q	0.26" (6.5mm)

Bolt pattern for both

DW-820-13 1200A dual 45mm



Rating - 1200A
 H - 92mm
 W - 171mm
 L - 82mm incl. tang
 Mtng. holes -to fit our insulators.

DW-820-2 600A 45mm clip



Rating - 630A
 H - 92mm
 W - 80mm
 L - 96.5mm incl. tang
 mtng. holes - drilled to match our insulator bolt pattern.

FC3R - 3" spring clip



Rating - 600A
 H - 4.5"
 W - 4.3"
 L - 1.5"
 Mtng. holes - 2 x 3/8" holes, 2" apart on clip centerline.

PT156 - 1-9/16" spring clip



Rating - 200A
 H - 95mm
 W - 40mm
 L - 32mm w/o tang
 Mtng hole - 1 x 1/2" on clip centerline.
 see below for tang info.

M164 - 1" spring clip

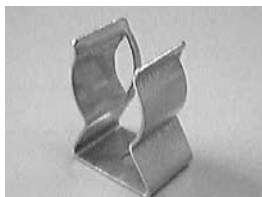

Rating - 60A
 H - 1.30"
 W - 1.12"
 L - 0.625"
 Mtng. hole - 0.26" on clip centerline.

Metric/UNC Adapter



Part No.	Stud	Receptacle
S13-R12	1/2-13 unc	M12
S38-R12	3/8-16 unc	M12
S12-R13	M12	1/2-13 unc
S12-R38	M12	3/8-16 unc

Extension for 3100302.20 & PT156

Use terminal tang when clip is mounted to non conducting support or alternate termination is required.

For use with PT156

part no. PT156-EXT



For use with 3100302.20

part no. 3100302.2