

## Eurofuses

European fuses are used in imported equipment, or in projects destined overseas. Eurofuses are available in two broad categories - bottle fuses and square body fuses. Both categories have many different types within the group. See the individual tables. All European fuses are current and energy limiting.

- Higher voltage rating insures compatible with Canadian voltage levels.
- Interchangeable with all imported makes.
- Built in blown fuse indicator.
- Current and energy limiting.

The following operating classifications are used for these fuses;

gL, gG, gT      General purpose characteristic for distribution  
aM                Back up characteristic for motor circuits  
aR/gR            Ultrafast characteristic for semiconductor circuits.

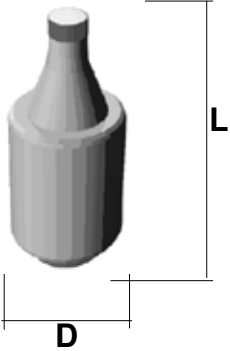
Type D Bottle fuses	General Specifications							
	Size	Part Number	Amp Range	D x L (mm)		Speed	Vac	I.R kA
	D01	Neozed	2-16A	11	36	gL	380V	100
	D02	Neozed	20-63A	15	36	gL	380V	
	D03	Neozed	80-100A	22	43	gL	380V	
	ND	1000204	2-25A	13	50	gT	500V	
	DII	D2gT	2-30A	22	50	gT	500V	
		D2gR	2-30A	22	50	gR	500V	
	DIII	D3gT	35-63A	28	50	gT	500V	
		D3gR	35-63A	28	50	gR	500V	
	DIVH	D4gT	80 - 100A	34	65	gT	500V	
	DVH	D5gT	125 - 200A	46	65	gT	500V	
	DIII	1001101	2 - 63A	28	70	gG	750V	

**Ratings Available: 2, 4, 6, 10, 16, 20, 25, 32, 35, 50, 63, 80, 100, 125, 160, 200A**

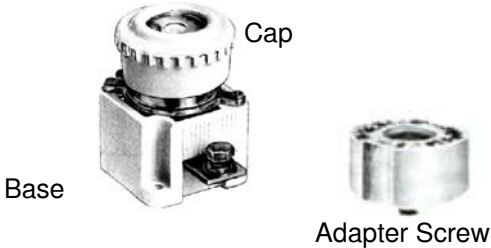
Accessories for bottle fuses		Part Numbers				
	Size	Thread pattern	Amp Rating	Base	Cap	Adapter Screw
	ND	E13	25	0038	DSC-1	-
	DII	E17	25	0039	DSC-2	RNG-D2
	DIII	E33	63	0040	DSC-3	RNG-D3
	DIVH	-	100	0041	DSC-4	-
	DVH	-	200	0042	DSC-5	-

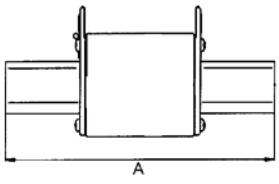
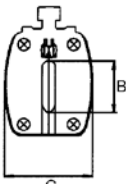
<b>'NH' Eurofuses</b>				<b>Size</b> <b>Taille</b>	<b>speed</b> <b>vitesse</b>	<b>Part</b> <b>number</b>	<b>Amperes</b>	<b>Vac</b>	<b>kA</b>																									
<b>DIN 43 620</b>																																		
   <table border="1" data-bbox="219 1003 544 1323"> <thead> <tr> <th>size taille</th> <th>'A' mm</th> <th>'B' mm</th> <th>'C' mm</th> </tr> </thead> <tbody> <tr> <td>'000'</td> <td>78</td> <td>15</td> <td>20</td> </tr> <tr> <td>'00'</td> <td>78</td> <td>15</td> <td>29</td> </tr> <tr> <td>'0'</td> <td>125</td> <td>15</td> <td>29</td> </tr> <tr> <td>'1'</td> <td>135</td> <td>20</td> <td>46</td> </tr> <tr> <td>'2'</td> <td>150</td> <td>26</td> <td>56</td> </tr> <tr> <td>'3'</td> <td>150</td> <td>32</td> <td>66</td> </tr> </tbody> </table>	size taille	'A' mm	'B' mm	'C' mm	'000'	78	15	20	'00'	78	15	29	'0'	125	15	29	'1'	135	20	46	'2'	150	26	56	'3'	150	32	66	'000'	gG	2045213	2, 4, 6, 10, 16, 20, 25, 32, 35, 40, 50A	690	120
	size taille	'A' mm	'B' mm	'C' mm																														
	'000'	78	15	20																														
	'00'	78	15	29																														
	'0'	125	15	29																														
	'1'	135	20	46																														
	'2'	150	26	56																														
	'3'	150	32	66																														
	'00'	gL	NH00gL	63, 80, 100, 125A	660	100																												
	'000'	gRL	2047734	16, 20, 25, 32 40, 50, 63, 80A	690	100																												
	'00'	gR	NH00gR	2, 4, 6, 10, 16, 63A 80, 100, 125, 160A	660	100																												
	'0'	gG	2021013	6, 10, 16, 20, 25A	690	120																												
		gL	NH0gL	32, 35, 50, 63A 80, 100, 125A	600	100																												
		gR	NH0gR	25, 32, 35, 50, 63A 80, 100, 125, 160A	660	100																												
	'1'	gR	2038404	16, 20, 25, 32, 40, 50A 63, 80, 100, 125, 160A	1000	100																												
gG		2021113	16, 20, 25, 32, 35, 50, 63A 80, 100, 125, 160, 200A 224, 250A	690	120																													
gR		2021120	16, 20, 25, 32, 35, 40, 50, 63A 80, 100,	690	100																													
'2'	aR	2021120	125, 160, 200, 224, 250, 315A																															
	gG	2021213	35, 40, 50, 63, 80, 100, 125A 160, 224, 250, 315, 350, 400A	690 600	120																													
'3'	aR	2021220	160, 200, 250, 315, 350, 400, 450A	660	100																													
	gG	2021313	300, 315, 355, 400A 425, 450, 500A	690 600	120																													
	aR	2021320	315, 350, 400, 450, 500, 550, 630, 770A	690	100																													

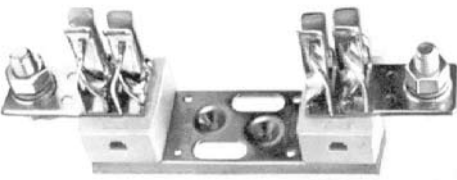
<b>'NH' Fuseholders</b>				
<b>Porte Fusibles 'NH'</b>				
<b>690 Vac</b>				
	<b>Part</b> <b>number</b>	<b>Fuse Size</b> <b>Taille</b>	<b># Poles</b>	<b>Max Amps</b>
	2100101	NH00/000	1	160A
	2100103		3	
	2100204	NH0	1	160A
	2100301	NH1	1	250A
	2100303		3	
	2100401	NH2	1	400A
	2100403		3	
	2100501	NH3	1	630A
	2138401	NH0	1	160A

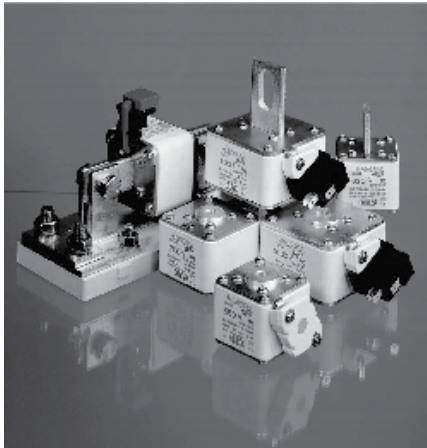

## DIN 43 625 Ultrafast

Square body rectifier fuses are used in large drives and power conversion equipment where larger amp ratings and superior short circuit performance are required. SIBA UR fuses are fully compatible with other manufacturers' fuses.

- Integral blown fuse indicator and microswitch bracket
- extremely low levels of energy let-thru
- N. American and European pattern dimensions
-  approved

DIN 43625 fuses come in 5 case sizes - 000, 00, 1, 2, & 3. Within these case sizes - UR fuses come in two voltage ratings (700 & 1300Vac) and two fixing centers (80 and 110mm). These fuses can easily be fitted with a microswitch for remote annunciation, or may be used without this option.

### DC Application

URS series fuses can be used on DC circuits with voltage levels dictated by the time constant of the circuit ( $I/r$ ) is known. Shorter time constants are easier duty on the fuse and so higher DC voltages can be tolerated. Usually, time constants are 20ms or less.

Refer to the chart at right to get the equivalent working DC voltage once the time constant is known.

**DC de-rating factors**

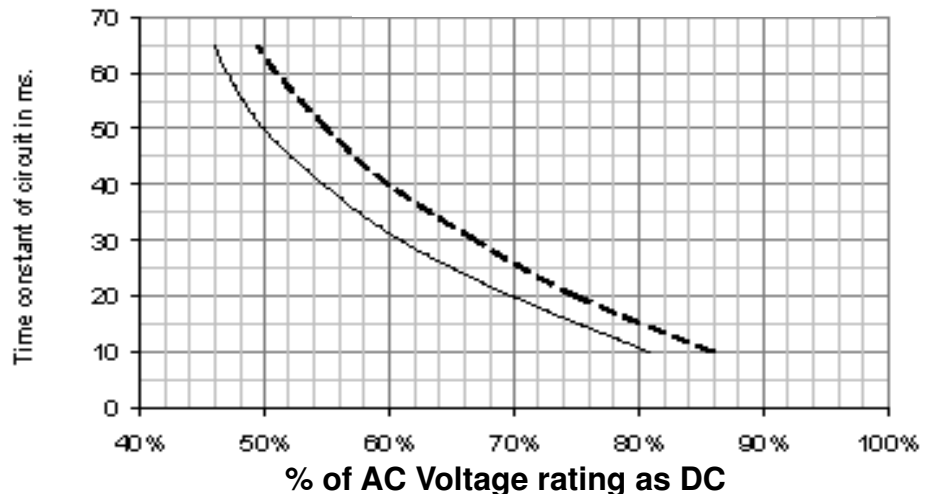

	000 & 00	SBQ1	SBQ2	SBQ3
<b>Dotted Curve</b>	<=250A	<=250A	<=400A	<=630A
<b>Solid Curve</b>	>250A	>250A	>400A	>630A

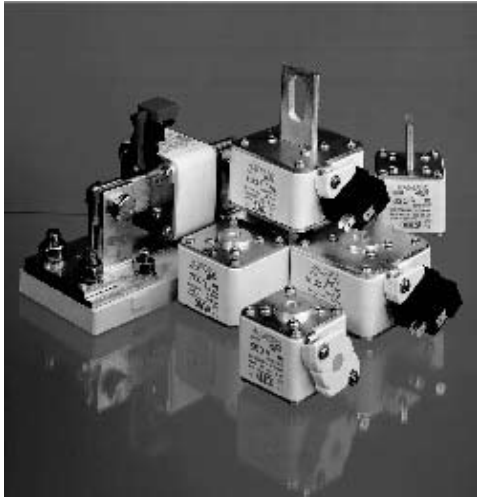
N.A Pattern SQB 1 - 3 with tags		Size Taille	Vac	I.R rms	Part number	Amperes
 	SQB1 D80	700	200	2061632	63, 80, 100, 125, 160, 200, 250, 315, 350, 400, 450, 500, 550, 630, 700, 800A	
		690			900A	
	SQB2 D80	700	200	2062632	400, 450, 500, 550, 630, 700, 800, 900, 1000A	
		600			1100, 1250A	
	SQB3 D80	700	200	2063632	500, 550, 630, 700, 800, 900, 1000, 1100, 1250, 1400A	
		600			1500, 1600A	
	SQB1 D110	700	200	2061832	63, 80, 100, 125, 160, 200, 250, 315, 350, 400, 450, 500, 550, 630, 700, 800A	
		600			900A	
	SQB2 D110	700	200	2062832	400, 450, 500, 550, 630, 700, 800, 900, 1000A	
		600			1100, 1250A	
	SQB3 D110	700	200	2063832	500, 550, 630, 700, 800, 900, 1000, 1100, 1250, 1400A	
		600			1500, 1600A	
	SQB1 D110	1300	100	2071832	63, 80, 100, 125, 160, 200, 250, 280, 315, 350, 400, 450A,	
		1200			500, 550, 630A	
	SQB2 D110	1300	100	2072832	250, 280, 315, 350, 400, 450, 500, 550A	
1200		630, 700A				
1100		800A				
SQB3 D110	1300	100	2073832	315, 350, 400, 450, 500, 550, 630, 700, 800, 900A		
	1000			1000, 1100A		
	900			1250, 1400A		

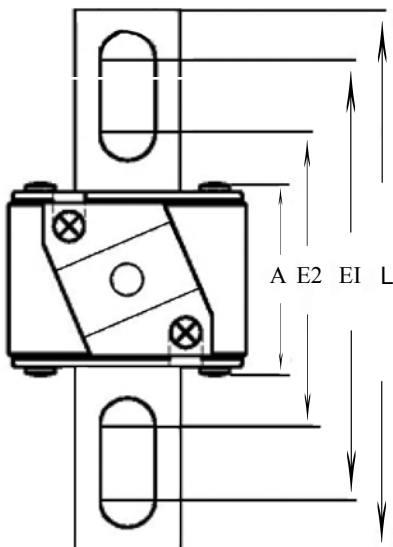
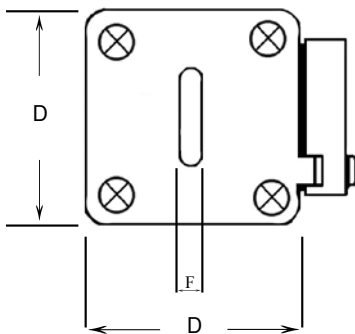

SQB

Size Taille	N.A dimensions (mm)								
	DIN	Part no.	L	A	EI	E2	D	F	
1	80mm	2061632	134	47.5	109	68	51	6	
	110mm	2061832	154	47.5	128	94	51	6	
2	80mm	2062632	134	47.5	109	73	60	6	
	110mm	2062832	154	47.5	128	94	60	6	
3	80mm	2063632	134	49.0	109	75	73	6	
	110mm	2063832	154	49.0	128	94	73	6	
1		2071832	157	70.5	132	96	51	6	
2	110mm	2072832	157	70.5	132	96	60	6	
3		2073832	157	70.5	132	98	73	6	

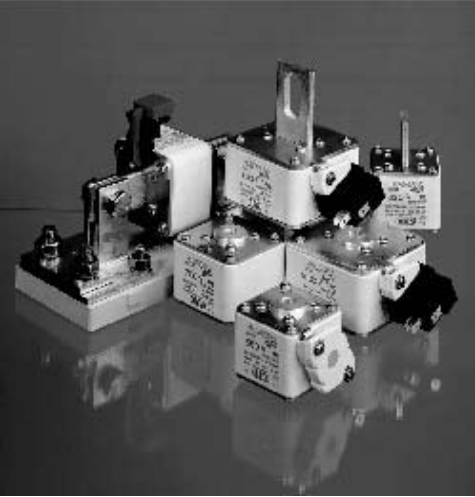
EURO Pattern SQB 1 - 3 with tags		Size Taille	Vac	I.R rms	Part number	Amperes
	SQB1 D80	700	200	2061232	63, 80, 100, 125, 160, 200, 250, 315, 350, 400, 450, 500, 550, 630, 700, 800A,	
		600	200			900A
	SQB2 D80	700	200	2062232	400, 450, 500, 550, 630, 700, 800, 900, 1000A	
		600	200			1100, 1250A
	SQB3 D80	700	200	2063232	500, 550, 630, 700, 800, 900, 1000, 1100, 1250, 1400A,	
		600	200			1500, 1600A
	SQB1 D110	660	200	2061532	63, 80, 100, 125, 160, 200, 250, 315, 350, 400, 450, 500, 550, 630, 700, 800, (900A@600V)	
	SQB2 D110		200	2062532	400, 450, 500, 550, 630, 700, 800, 900, 1000, 1100, 1250A	
	SQB3 D110		200	2063532	500, 550, 630, 700, 800, 900, 1000, 1100, 1250, 1400, 1500, 1600A	
	SQB1 D110	1250	1200	100	2071532	50, 63, 80, 100, 125, 160, 200, 250, 280, 315, 350, 400, 450A
			1200			500, 550, 630
	SQB2 D110	1250	1200	100	2072532	250, 280, 315, 350, 400, 450, 500, 550, 630A
1200			700A, (800A @1100V)			
SQB3 D110	1250	1000	100	2073532	315, 350, 400, 450, 500, 550, 630, 700, 800, 900A	
		1000			1000, 1100A	
		900			1000, 1250, 1400A	

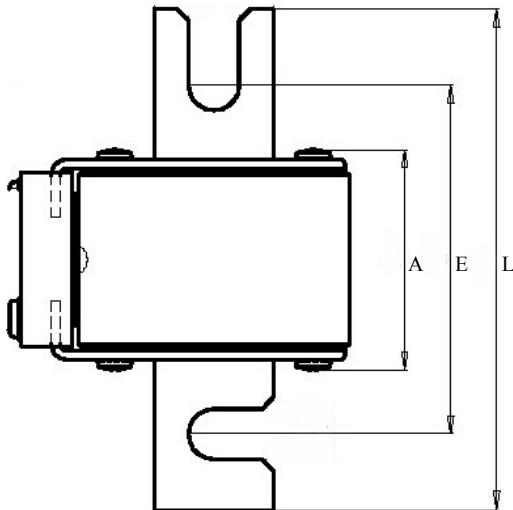
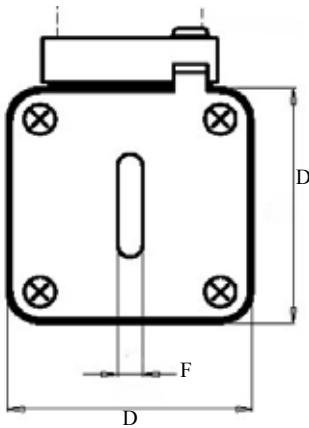

Size Taille SQB	DIN	Part no.	Dimensions (mm)				
			L	A	E	D	F
SQB1	80mm	2061232	110	47.5	76	51	6
	110mm	2061532	134	47.5	106	51	6
SQB2	80mm	2062232	110	47.5	76	60	6
	110mm	2062532	134	47.5	106	60	6
SQB3	80mm	2063232	110	49	76	73	6
	110mm	2063532	134	49	106	73	6
SQB1	110mm	2071532	138	70.5	106	73	6
SQB2	110mm	2072532	138	70.5	106	73	6
SQB3	110mm	2073532	138	70.5	106	73	6

N.A & Euro SQB 1-3 face mount		Size Taille	Vac	I.R rms	Part number	Amperes
<b>North American Pattern - UNC threads</b>						
SQB1	700	200	2066432	63, 80, 100, 125, 160, 200A 250, 315, 350, 400, 450, 500A 550, 630, 700, 800A		
	600			900A		
SQB2	700	200	2067432	400, 450, 500, 550, 630, 700, 800, 900, 1000A		
	600			1100, 1250A		
SQB3	700	200	2068432	500, 550, 630, 700, 800, 900A 1000, 1100, 1250, 1400A		
	600			1500, 1600A		
SQB1	1300	100	2076432	50, 63, 80, 100, 125, 160, 200A 250, 315, 350, 400, 450A		
	1200			500, 550, 630A		
SQB2	1300	100	2077432	250, 280, 315, 350, 400, 550, 500, 550, 630A		
	1200			700A, (800A @ 1100V)		
SQB3	1300	100	2078432	315, 350, 400, 450, 500, 550, 630, 700, 800, 900A		
	1000			1000, 1100, (1250, 1400A @ 900V)		
<b>European Pattern - Metric threads</b>						
SQB1	660	200	2066132	63, 80, 100, 125, 160, 200A 250, 315, 350, 400, 450, 500A 550, 630, 700, 800A		
	600			900A		
SQB2	660	200	2067132	400, 450, 500, 550, 630, 700, 800, 900, 1000A		
	600			1100, 1250,		
SQB3	660	200	2068132	500, 550, 630, 700, 800, 900A 1000, 1100, 1250, 1400A		
	600			1500, 1600A		
SQB1	1250	100	2076132	50, 63, 80, 100, 125, 160, 200A 250, 280, 315, 350, 400, 450A		
	1200			500, 550, 630A		
SQB2	1250	100	2077132	250, 280, 315, 350, 400, 450A 500, 550, 630A		
	1200			700A, (800A @ 1100V)		
SQB3	1250	100	2078132	315, 350, 400, 450, 500, 550, 630A 700, 800, 900A		
	1000			1000, 1100A, (1250, 1400A @ 900V)		

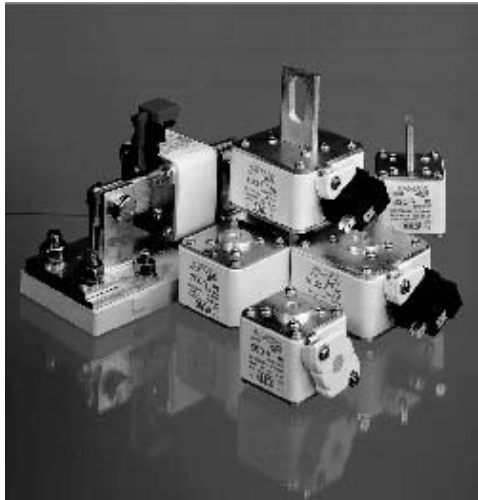

Size Taille SQB	Vac	Part no.	Dimensions (mm)		
			D	L	Thread
1	700	2066432	51	50.5	5/16-18unc
		2066132	51	50.5	M8
		2067432	60	50.5	3/8-16 unc
2067132		60	50.5	M10	
3		2068432	73	50.5	1/2-13unc
		2068132	73	50.5	M12)
1	1300	2076432	51	73.5	5/16-18unc
		2076132	51	73.5	M8
		2077432	60	73.5	3/8-16unc
2		2077132	60	73.5	M10
		2078432	73	73.5	1/2-13unc
3		2078132	73	73.5	M12

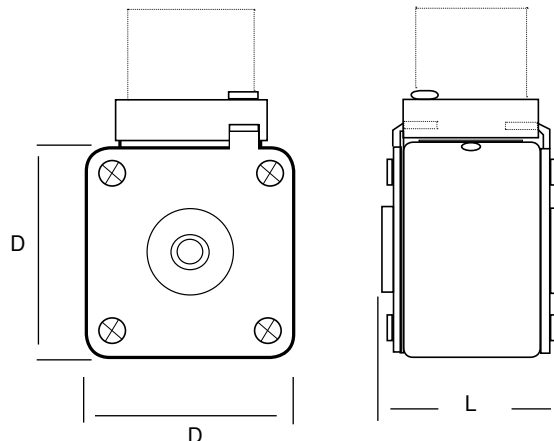



**Electrical Characteristics 600-690/700V SQB 1 - 3 Operating class "aR"**

Body Size	Amp rating	IEC voltage (Vac)	UL voltage (Vac)	Power Loss (W)	Pre-arcing 1 <sup>2t</sup> (A <sup>2</sup> s)	Total I <sup>2t</sup> 600V A <sup>2</sup> s
SQB1	63	690	700	19	160	850
	80	690	700	24	260	1400
	100	690	700	30	420	2300
	125	690	700	35	600	3100
	160	690	700	40	1400	7500
	200	690	700	44	2400	13000
	250	690	700	51	3700	21000
	315	690	700	59	6600	39000
	350	690	700	61	9900	55000
	400	690	700	65	17000	96000
	450	690	700	70	22000	130000
	500	690	700	72	31000	180000
	550	690	700	75	41000	250000
	630	690	700	80	61000	370000
	700 *	690	700	85	86000	490000
800 *	690	700	99	120000	750000	
900 *	690	700	105	170000	990000	
* TESTED AT 1.05 X U <sub>N</sub>						
	Amp rating	IEC voltage (Vac)	UL voltage (Vac)	Power Loss (W)	Pre-arcing 1 <sup>2t</sup> (A <sup>2</sup> s)	Total I <sup>2t</sup> 600V A <sup>2</sup> s
SQB2	400	690	700	65	13000	75000
	450	690	700	75	18000	110000
	500	690	700	80	26000	150000
	550	690	700	85	36000	195000
	630	690	700	94	55000	300000
	700	690	700	99	74000	410000
	800	690	700	108	100000	580000
	900 *	690	700	111	170000	950000
	1000 *	690	700	115	230000	1260000
	1100 *	600	600	130	290000	1600000
	1250 *	600	600	140	370000	2140000
	* TESTED AT 1.05 X U <sub>N</sub>					
	Amp rating	IEC voltage (Vac)	UL voltage (Vac)	Power Loss (W)	Pre-arcing 1 <sup>2t</sup> (A <sup>2</sup> s)	Total I <sup>2t</sup> 600V A <sup>2</sup> s
SQB3	500	690	700	90	18000	100000
	550	690	700	100	22000	130000
	630	690	700	108	31000	190000
	700	690	700	113	50000	300000
	800	690	700	118	85000	480000
	900	690	700	120	115000	660000
	1000	690	700	131	140000	860000
	1100 *	690	700	136	210000	1200000
	1250 *	690	700	147	290000	1750000
	1400 *	690	700	161	380000	2200000
	1500 *	600	600	170	490000	3000000
	1600 *	600	600	190	590000	3700000

TESTED AT 1.05 X U<sub>N</sub>

**Electrical Characteristics 900-1250/1300 SQB 1 - 3 Operating class "aR"**

Body Size	Amp rating	IEC voltage (Vac)	UL voltage (Vac)	Power Loss (W)	Pre-arcing 1 <sup>st</sup> (A <sup>2</sup> s)	Total I <sup>2</sup> t @1000V A <sup>2</sup> s
SQB1	50	1250	1300	29	130	730
	63	1250	1300	32	250	1400
	80	1250	1300	35	410	2300
	100	1250	1300	38	930	5200
	125	1250	1300	41	1400	7800
	160	1250	1300	45	2500	14000
	200	1250	1300	49	4600	25000
	250	1100	1200	58	8400	46000
	280	1250	1300	60	12500	64000
	315	1250	1300	67	15000	81000
	350	1250	1300	70	22000	120000
	400	1250	1300	75	36000	200000
	450	1250	1300	80	44000	250000
	500	1100	1200	87	66000	340000
	550	1100	1200	94	83000	430000
630	1100	1200	99	126000	670000	
	Amp rating	IEC voltage (Vac)	UL voltage (Vac)	Power Loss (W)	Pre-arcing 1 <sup>st</sup> (A <sup>2</sup> s)	Total I <sup>2</sup> t @1000V A <sup>2</sup> s
SQB2	250	1250	1300	55	8200	45000
	280	1250	1300	59	9900	56000
	315	1250	1300	66	14000	78000
	350	1250	1300	71	20000	110000
	400	1250	1300	75	31000	170000
	450	1250	1300	80	42000	240000
	500	1250	1300	90	56000	310000
	550	1100	1300	105	71000	350000
	630	1250	1300	110	105000	540000
	700	1100	1200	115	148000	710000
800	1100	1100	123	225000	1180000	
	Amp rating	IEC voltage (Vac)	UL voltage (Vac)	Power Loss (W)	Pre-arcing 1 <sup>st</sup> (A <sup>2</sup> s)	Total I <sup>2</sup> t @1000V A <sup>2</sup> s
SQB3	315	1250	1300	83	11000	60000
	350	1250	1300	85	15000	90000
	400	1250	1300	92	22000	130000
	450	1250	1300	99	33000	190000
	500	1250	1300	110	42000	230000
	550	1250	1300	115	56000	320000
	630	1250	1300	120	83000	480000
	700	1250	1200	131	113000	640000
	800	1250	1300	135	201000	1070000
	900	1200	1300	140	236000	1300000
	1000	1000	1000	150	350000	1900000
	1100	1000	1000	174	443000	2400000
	1250	900	-	198	652000	3300000
1400	900	-	210	852000	3900000	



**Time Current Curves for  
600-690/700V  
SQB 1-3**

**Time Current Characteristics**

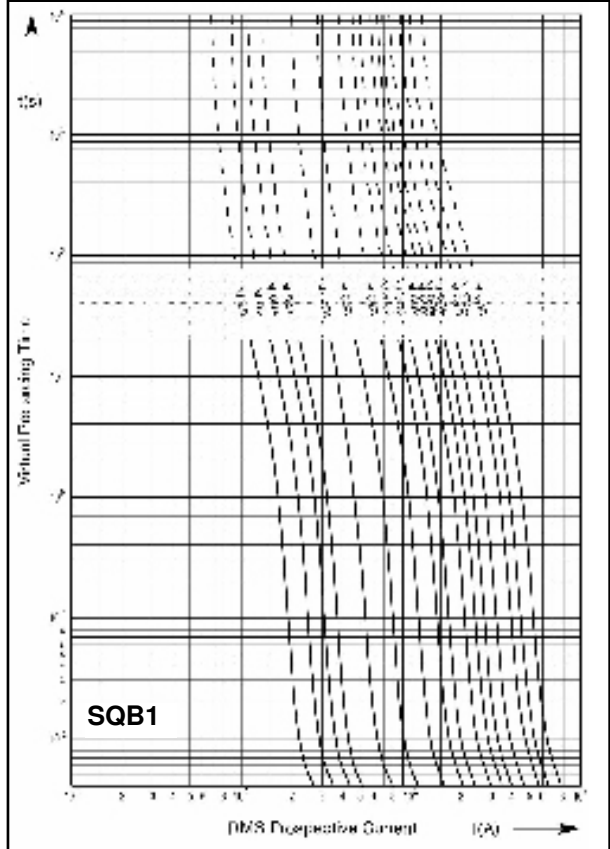

**Time Current Characteristics**

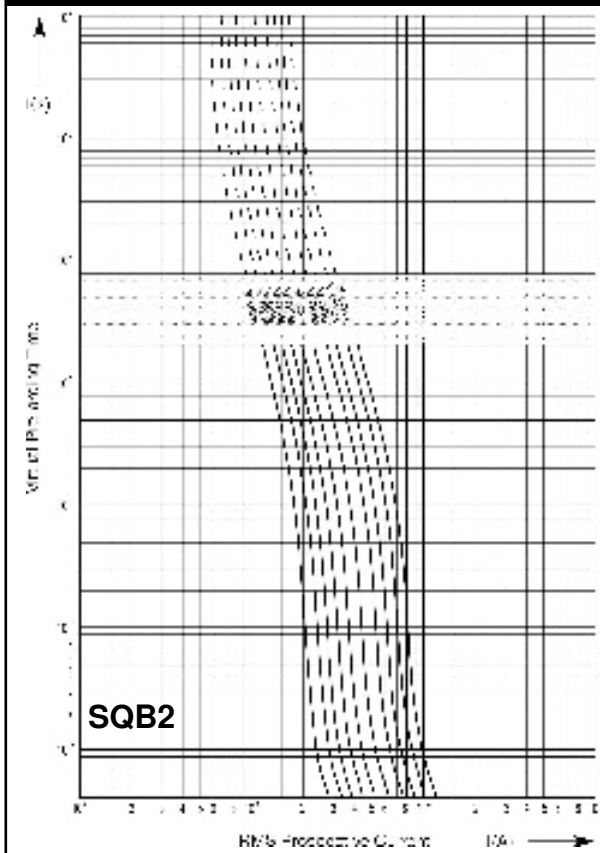

**Time Current Characteristics**

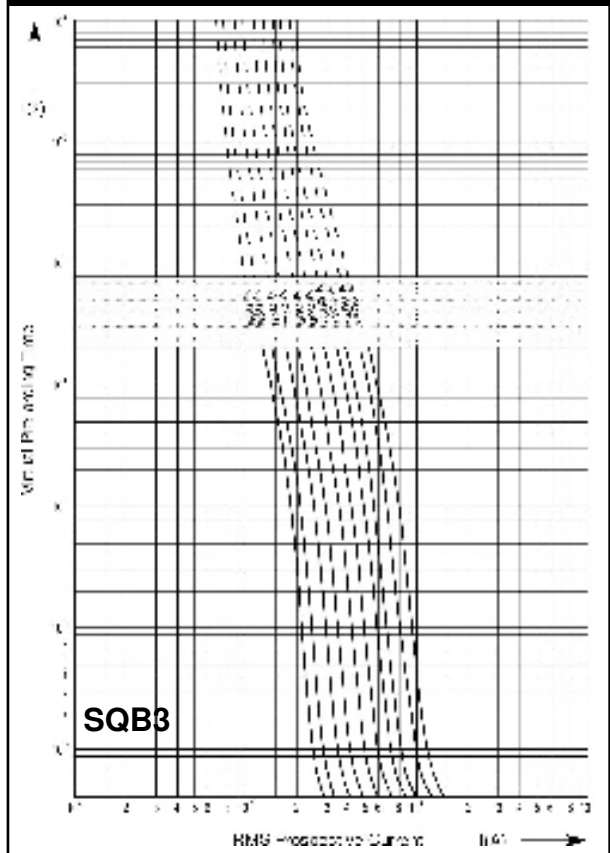

### Time Current Characteristics

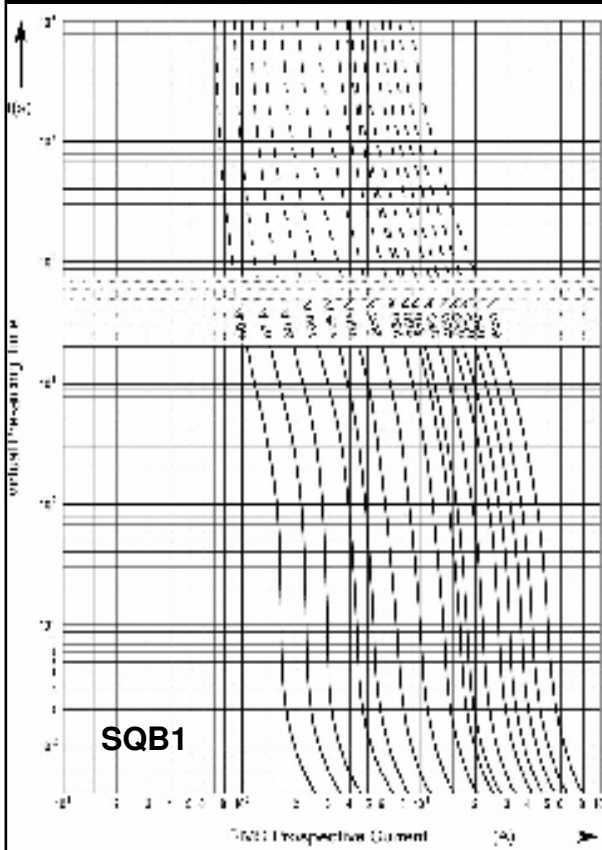

### Time Current Curves for 900-1250/1300V SQB 1-3

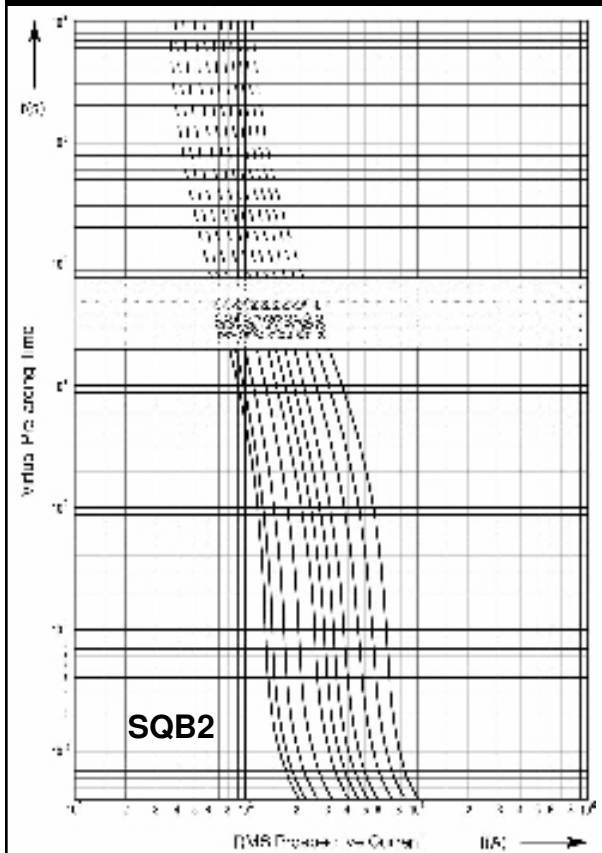

### Time Current Characteristics

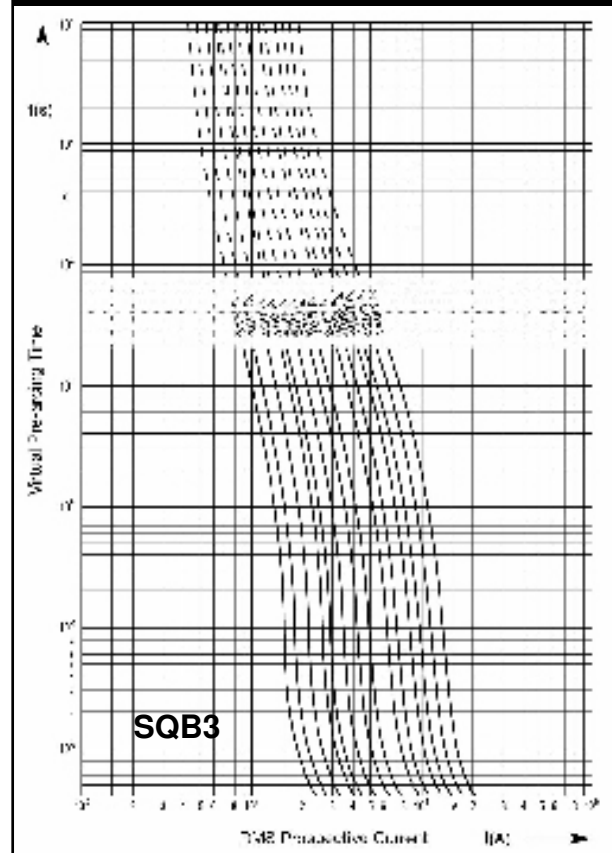

### Time Current Characteristics

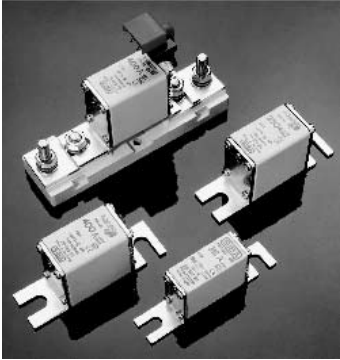

### Electrical Characteristics 690/700V Operating class "gRL"

SIZE 000 & 00 - D80	Size Taille	I.R kA rms	Vac	Part number	Amperes
	 000	200	690	*2055834	16, 20, 25, 32, 40, 50, 63, 80A
		200	700	*2055820	100, 125, 160, 200, 250, 315A
		200	700	2028220	32, 35, 40, 50, 63, 80, 100, 125, 160, 200, 250, 315A
	00	200	700	2018920	32, 35, 40, 50, 63, 80, 100, 125, 160, 200, 250, 315, 350, 400A
		200	700	*2041204	16, 20, 25A
		200	700	*2041220	32, 35, 40, 50, 63, 80, 100, 125A 160, 200, 250, 315, 350, 400A
00	200	1000	*2056220	32, 35, 40, 50, 63, 80, 100, 125, 160, 200, 250, 315A	

\* With bracket for micro switch

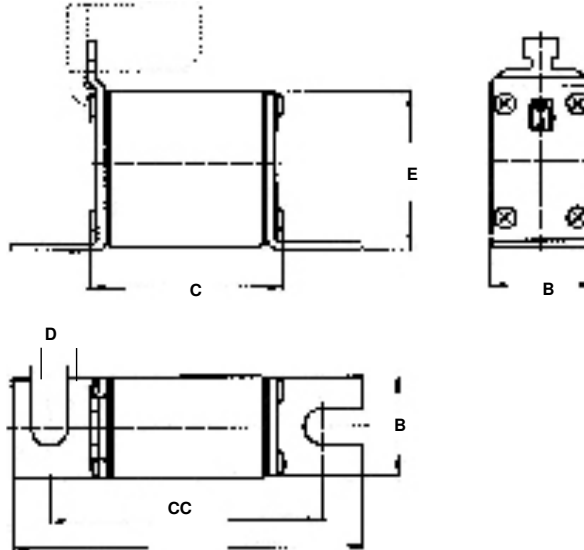

Dimensions (mm)		
	00	000
A	105	100
B	29.5	20.4
C	47	38
CC	80	80
D	10.3	8.5
E	28.8	20

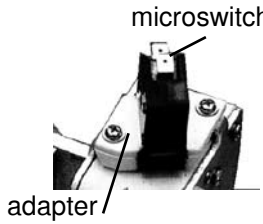
Accessories/ Accessoires	for/pour	
	Adaptor for SQB 80mm fuses	<b>2800102</b>
	Adapter for SQB 110mm fuses	<b>2800103</b>
	GL-Microswitch 250V / 10A	<b>2800104</b>
	GL-Microswitch for NH00 DIN 80 SBQ 1-3 250V / 5A one change over contact	<b>2800201</b>
	GL-Microswitch for NH00 DIN 80 NH000-4 250V / 5A one change over contact	<b>2800202</b>

Bases for DIN 43653 fuses	Part number	fuse type	Amps	E	Fig.
	21 189 01	1000V - 00, 000	400A	80	1
	21 313 01	900V - 1, 2, 3	630A	80	2
	21 313 02	900V - 1, 2, 3	1250A	80	2
	21 323 01	1400V - 1, 2, 3	630A	110	2
	21 323 02	1400V - 1, 2, 3	1250A	110	2

Figure 1



2118901 Fixing Center 80 mm	
A	4.96" (126 mm)
B	1.57" (40 mm)
C	0.50" (13 mm)
D	0.75" (19 mm)
E	3.15" (80 mm)
F	0.12" (3 mm)
G	1.73" (44 mm)
H	3.82" (97 mm)
I	0.26" (6.5 mm)
J	0.60" (15.5 mm)
K	0.63" (16 mm)
L <sub>(Max)</sub>	5.75" (146 mm)
M	M8
N	0.98" (25 mm)

## SQB 1-3 Bases

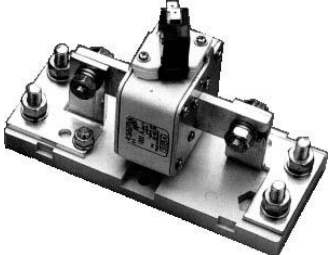
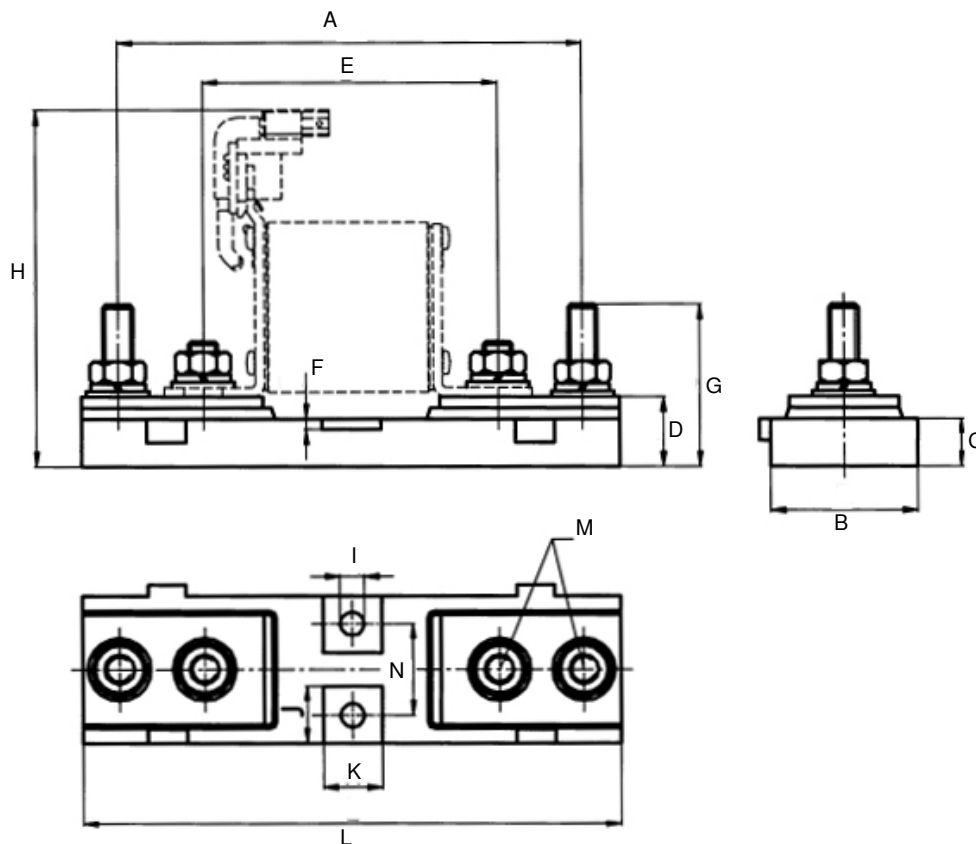
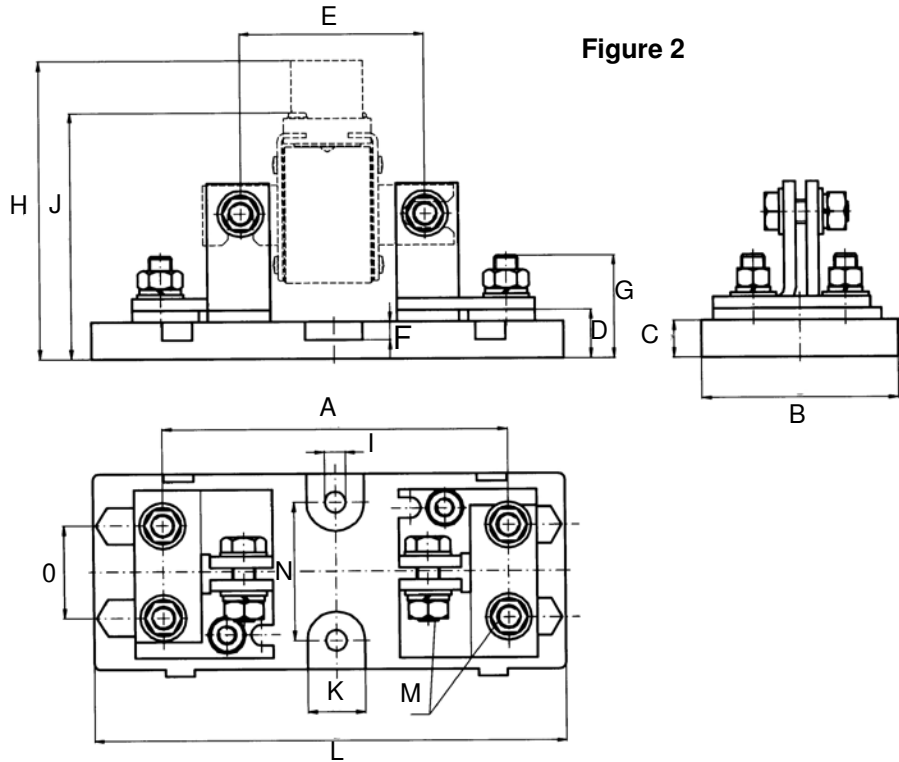

Figure 2

### 630A

2131301 Fixing Center 80 mm		2132301 Fixing Center 110 mm	
A	5.90" (150 mm)	A	7.10" (180 mm)
B	3.35" (85 mm)	B	3.35" (85 mm)
C	0.63" (16 mm)	C	0.63" (16 mm)
D	0.83" (21 mm)	D	0.83" (21 mm)
E	3.15" (90 mm)	E	4.33" (110 mm)
F	0.30" (8 mm)	F	0.30" (8 mm)
G	1.80" (46 mm)	G	1.80" (46 mm)
H (Size 1)	5.00" (127 mm)	H (Size 1)	5.00" (127 mm)
H (Size 2)	5.12" (130 mm)	H (Size 2)	5.12" (130 mm)
H (Size 3)	5.40" (137 mm)	H (Size 3)	5.40" (137 mm)
I	0.35" (9 mm)	I	0.35" (9 mm)
J (Size 1)	4.10" (104 mm)	J (Size 1)	4.10" (104 mm)
J (Size 2)	4.25" (108 mm)	J (Size 2)	4.25" (108 mm)
J (Size 3)	4.53" (115 mm)	J (Size 3)	4.53" (115 mm)
K	0.98" (25 mm)	K	0.98" (25 mm)
L (Max)	8.07" (205 mm)	L (Max)	8.07" (205 mm)
M	M10	M	M10
N	2.36" (60 mm)	N	2.36" (60 mm)
O	1.57" (40 mm)	O	1.57" (40 mm)

### 1250A

2131302 Fixing Center 80 mm		2132302 Fixing Center 110 mm	
A	5.90" (150 mm)	A	7.10" (180 mm)
B	3.35" (85 mm)	B	3.35" (85 mm)
C	0.63" (16 mm)	C	0.63" (16 mm)
D	0.83" (21 mm)	D	0.83" (21 mm)
E	3.15" (90 mm)	E	4.33" (110 mm)
F	0.30" (8 mm)	F	0.30" (8 mm)
G	1.80" (46 mm)	G	1.80" (46 mm)
H (Size 1)	5.00" (127 mm)	H (Size 1)	5.00" (127 mm)
H (Size 2)	5.12" (130 mm)	H (Size 2)	5.12" (130 mm)
H (Size 3)	5.40" (137 mm)	H (Size 3)	5.40" (137 mm)
I	0.35" (9 mm)	I	0.35" (9 mm)
J (Size 1)	4.10" (104 mm)	J (Size 1)	4.10" (104 mm)
J (Size 2)	4.25" (108 mm)	J (Size 2)	4.25" (108 mm)
J (Size 3)	4.53" (115 mm)	J (Size 3)	4.53" (115 mm)
K	0.98" (25 mm)	K	0.98" (25 mm)
L (Max)	8.07" (205 mm)	L (Max)	8.07" (205 mm)
M	M10	M	M10
N	2.36" (60 mm)	N	2.36" (60 mm)
O	1.57" (40 mm)	O	1.57" (40 mm)